



## MOBILE LIGHT TOWER BATTERY POWERED

Bravo light tower is a unique portable lighting solution for a wide range of jobs, events and projects, indoors and outdoor. provides powerful illumination in a compact, maneuverable design for ultimate versatility, the linking capability allows for flexibility and versatility in lighting events and jobsites. And, because it's powered by a standard 120V outlet, there are no harmful fuel emissions. Bravo Tower is a clean and safe choice for temporary lighting needs of all kinds.

### CLEAN

- Battery powered and produce zero carbon emissions.

### QUIET

- Silent operation is ideal for music and other special events, and any application in which sound is a concern.

### MOBILITY

- lighter and more compact than traditional mobile light tower

### COST EFFECTIVE

- Lowest total cost of ownership for a light tower- no service interval, no diesel fuel.

### WIDE APPLICATION

- Lighting, Camera, Broadcast, 5G station ~

# BNE100-BL

## Mobile Light Tower

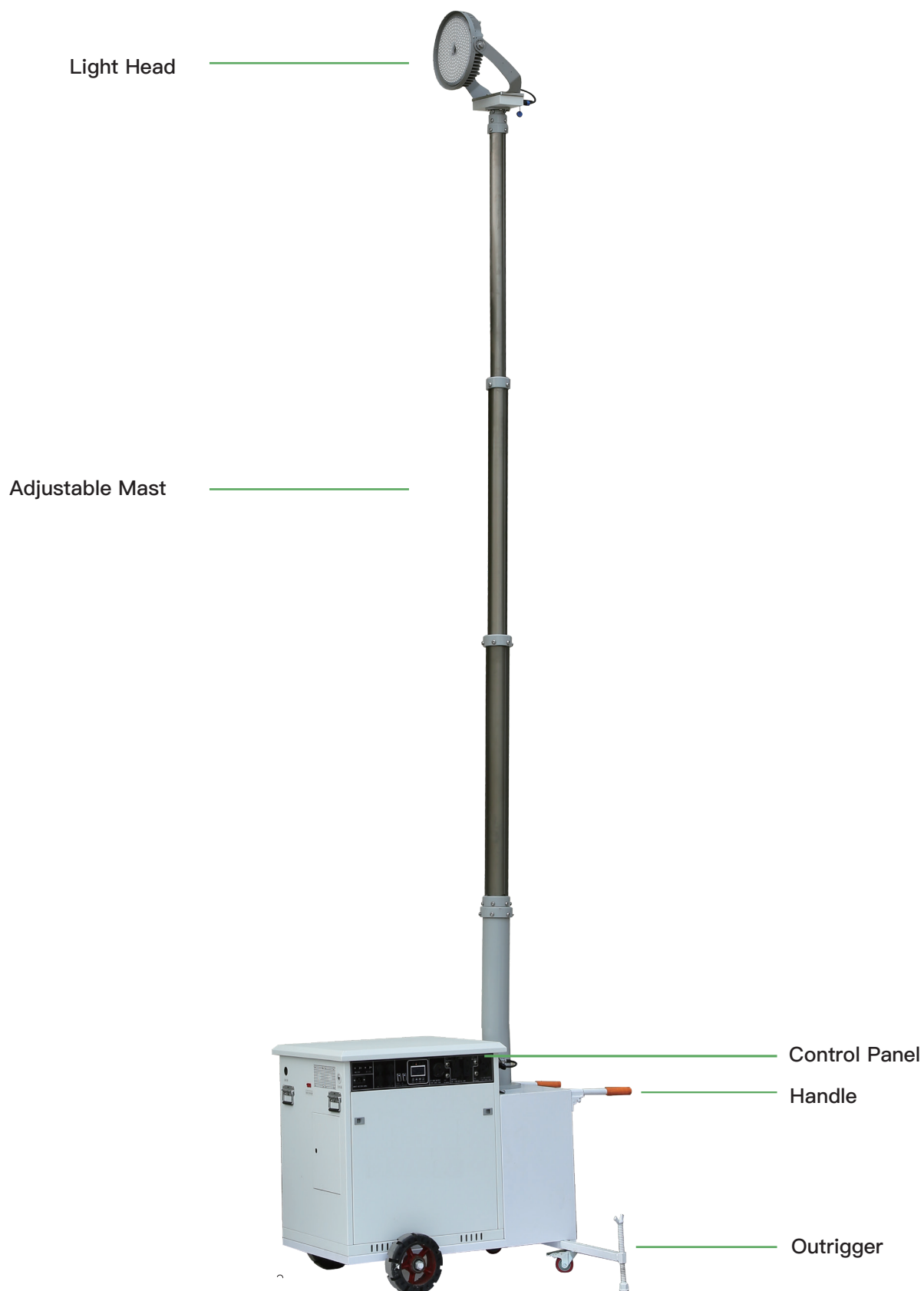

# BNE100-BL

Mobile Light Tower

## Dimension

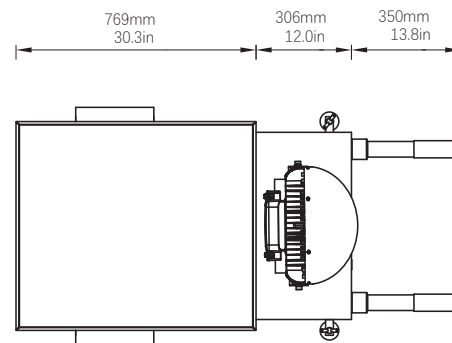
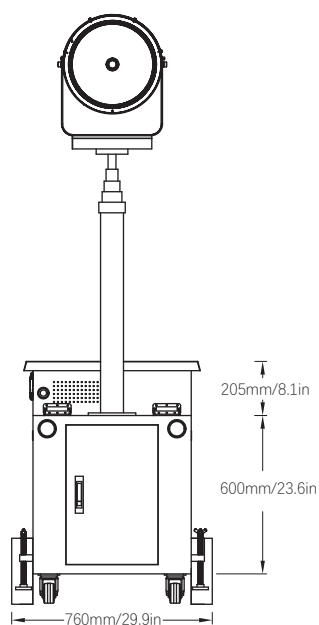
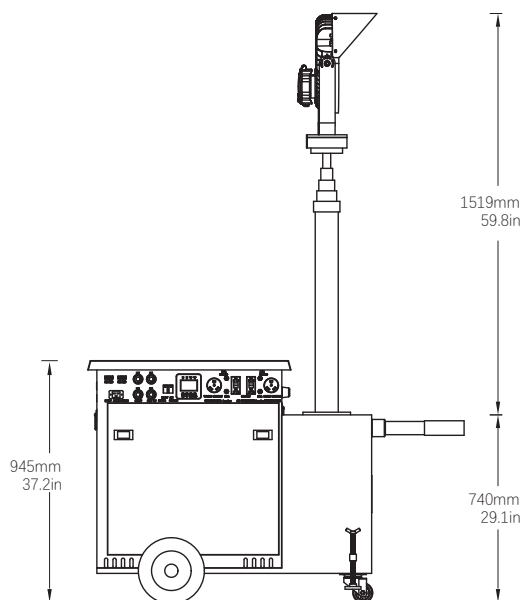
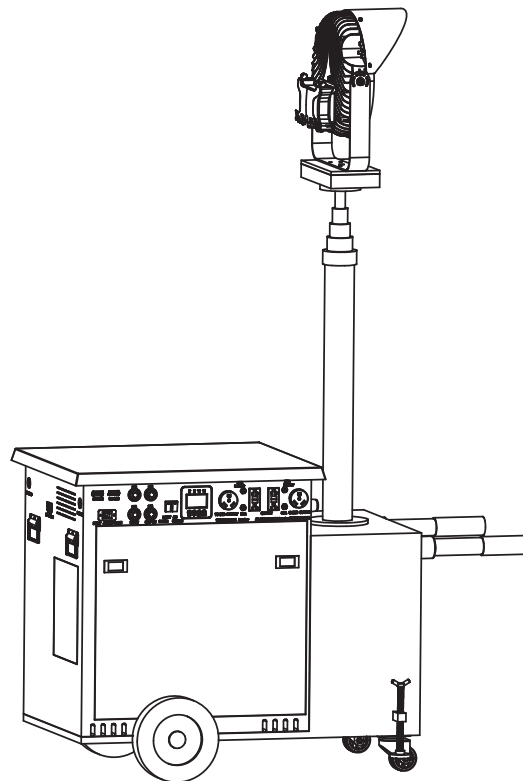
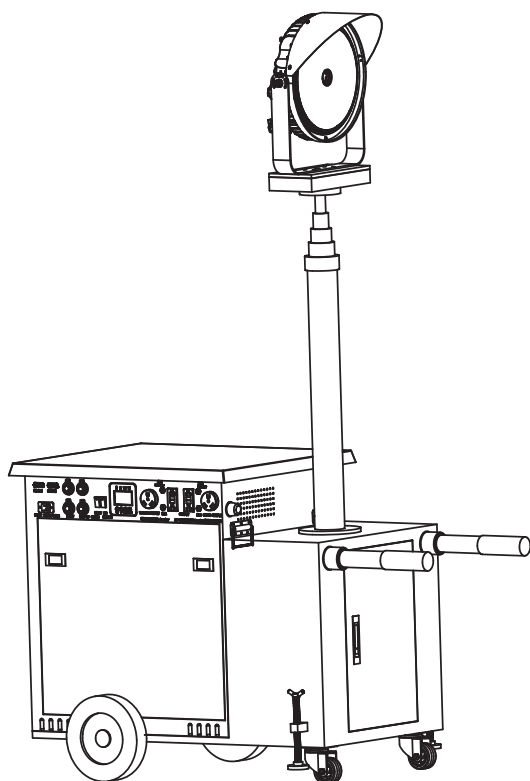

## Specification

### Main Features

Battery Charging Type	Electric AC120V/240V
System Voltage	DC24V
Working Temp.	-20°C~50°C
Charging Time	2 hours
Running Time	16 hours

### Lighting

Type	LED flood light
Wattage	300W
Lumen Output	45,000lm
CCT	5,700K
IP Rating	IP66

### Battery

Type	Lithium Iron
Capacity	10KWh
Voltage	48~51.2Vdc
Discharge Current	100A

### Inverter

Power	3KW
Output	AC120V/240V

### Mast

Type	pneumatic
Height	1.5~4.5m
Material	Aluminum

### Shipment

Packed Dimension	143*89*118cm
Gross Weight	150kg/330lb
Loading Qty	40GP/HQ: 30pcs